

# RendaClad

Seamless Rendered Rainscreen Cladding for Framed Structures



## About Benx

At Benx, we lead the way in the supply of external wall insulation systems and high-quality decorative renders to the building and construction industry.

Suitable for both low-rise and high-rise buildings our extensive range of innovative insulation systems are perfect for a decorative uplift to old buildings, or new build applications.

Our products, which have been rigorously tested by the BBA, CERAM and the BRE have been used throughout the UK and continental Europe for over 30 years and greatly improve the thermal efficiency of any building and helps cut CO2 emissions.

Our partnership approach is to assist you from the specification process right through to contractor selection, product application and completion of the works.

We'll make sure that the products not only suit their purpose but also provide the best possible value for your project. We will also assist with the selection of experienced and approved contractors, monitor their work and ensure that the application of our products are undertaken to the highest standard.

Contractor, specifier or architect, you can expect exceptional service and the best technical support throughout your project.



## About RendaClad

RendaClad has primarily been developed for applying a seamless rendered rainscreen system to a timber frame structure. It replaces the need to build a blockwork façade, finishing with low performance cementitious renders. It increases the speed of construction, reduces the building footprint, improves the logistics of supply and storage all at a lower cost than traditional construction methods. RendaClad is a full façade system made up of many carefully selected components. These components have been rigorously tested individually and as an entire system, making it one of a very few BBA approved systems of its type, providing the reassurance that it will perform over the long term.

Non-proprietary render-to-board applications have previously been fraught with issues relating to cracking and de-lamination. RendaClad provides a low-cost solution and is able to accommodate the expected settlement and differential movement within timber frame construction with the use of movement beads. In addition, silicone render finishes give long term durability and a high-resistance to dirt retention and algal spoiling, resulting in a highly durable render system with a minimum life expectancy of 30 years.

### Ventilated Cavity

RendaClad has been primarily developed for use on timber frame construction providing a simple solution to ensure a fully ventilated and drained cavity is maintained within the wall structure, meeting the requirements of the NHBC and TRADA. The system can be applied to any wall structure, lightweight steel frame or masonry construction.



## The System

It is not essential, however, TRADA and the NHBC recommend a ventilated cavity behind any cladding system applied to timber frame construction. Traditional methods using Expanded Metal Lath (EML) with a sand and cement render finish uses a mix of three materials (timber/metal/masonry) which expands and contracts differently causing the render to crack. This is not an issue with RendaClad. Thermal values to meet Part L building regulation standards for new build properties can be met and exceeded within a typical 140mm timber frame structure. To utilise space and minimise the thickness of the wall, our recommendation is that RendaClad becomes the natural solution.



## Three methods of application

### Timber Batten

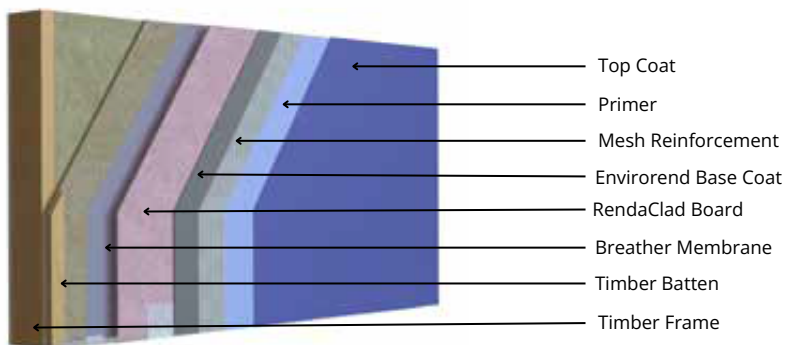

### Helping Hand Bracket

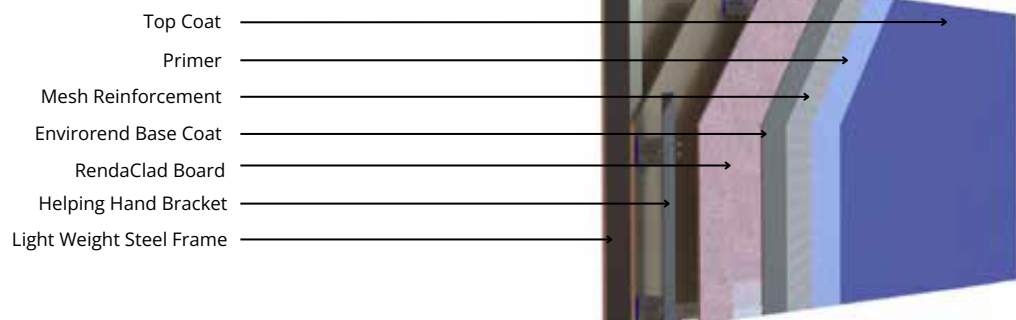

### Top Hat Section

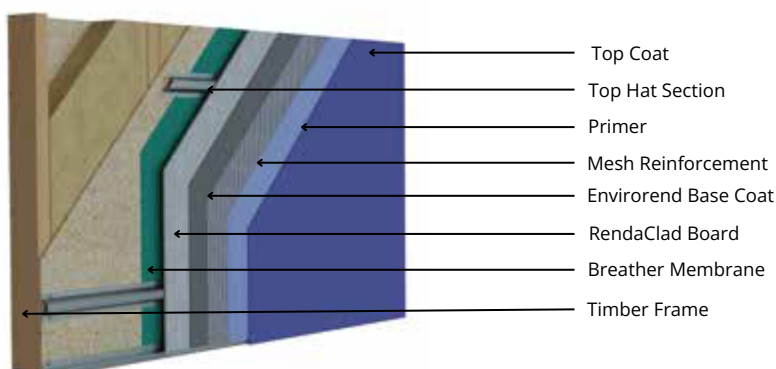

## The Design

By engaging with Benx at an early stage, we can assist in the design of detailing by providing standard and bespoke drawings specific to the building. By doing this we can improve performance of the structure and propose cost savings.



*"As a business we are well aware of the challenges that face the industry particularly in the South West in terms of resources, quality, availability of materials, climate and innovation. Having first attended a joint presentation by Benx (SPSenvirowall) and CESW on both product and modern methods of build respectively, we have since worked in collaboration to deliver schemes in the South West both ahead of programme and within budget. This has involved a great degree of support and early design involvement with respective businesses including third party supply chain that Benx have readily provided which has contributed considerably to the success to date. As part of the two way collaboration and commitment between the businesses we have used an open book method of procurement, sharing pipeline and continuity of work on a regular basis."*

**Tony Lane**  
Commercial Director  
GallifordTry



*"Having used Benx on two large Passivhaus schemes we have been impressed by both the service offered at specification stage and the quality of the final product. As a practice we would not hesitate in specifying Benx in the future."*

**Ben Warren**  
Associate  
Mitchell Architects



# The Benefits



Less Materials



Less Money



Less Tradesmen



Less Weight



Less Permeable



Less Time



Less Storage



Less Ageing



Less Maintenance



Less Waiting

## Speed of Construction

The application of RendaClad panels and the rendering of high performance thin coat renders is far quicker than the laying of traditional bricks and blocks and application of thick monocouche renders. The external facades can be quickly completed providing a street scape conducive to increasing the purchasing interest in the property.

## Testing and Accreditation

The system is fully accredited with BBA, NHBC, TRADA and STA approval.

## Cost Effective

Highly cost effective when compared to more traditional methods of construction.

## Extensive Track Record

Projects in the UK in excess of 10 years old. Accelerated ageing tests undertaken giving a life expectancy in excess of 30 years.

## Durability

The use of proprietary polymer modified and silicone renders give it weather resistance and durability far beyond traditional finishes.

## Lightweight

Savings can be made in the substructure due to the lightweight nature of the system.

## Guaranteed

10 year guarantee.

## Availability

All products are readily available in stock within our network of regional depots or on short lead times.



## Crack Resistant

The flexibility of the renders and reinforcing mesh provide resistance to cracking from the movement of the substrate.

## Non-Combustible

RendaFlex Lite is classified A1 non-combustible.

## Low Maintenance

The high performance silicone renders maintain their appearance far longer than traditional monocouche renders and do not spoil easily.

## Aesthetics

There is an extensive range of finishes including flexible brick slips matching a large range of traditional clay brick finishes, including blends and an extensive range of textured render colours to meet clients design requirements.

## Savings

Due to the speed of the application and the reduced depth of the overall system, significant savings can be made in the scaffold costs.

## Strength

The finished panel gives a very high degree of impact strength and is highly durable.

## Site Storage

The volume of building materials required is massively reduced so there is no requirement to store bricks or blocks on site. Coverage rates of render is four times greater than that of traditional renders.

## Versatility of Design

Several finishes are available from coloured renders to brick slips, to enhance the look your building's façade and meet the approval of the Local Authority Planning departments requirements



**Benx**

Lonsdale Chambers  
Lonsdale Street  
Stoke-on-Trent  
Staffordshire  
ST4 4BT

T: 0845 519 8641  
[www.benx.co.uk](http://www.benx.co.uk)