

Note:-
Adopt same
head detail
for drainage
with door
openings

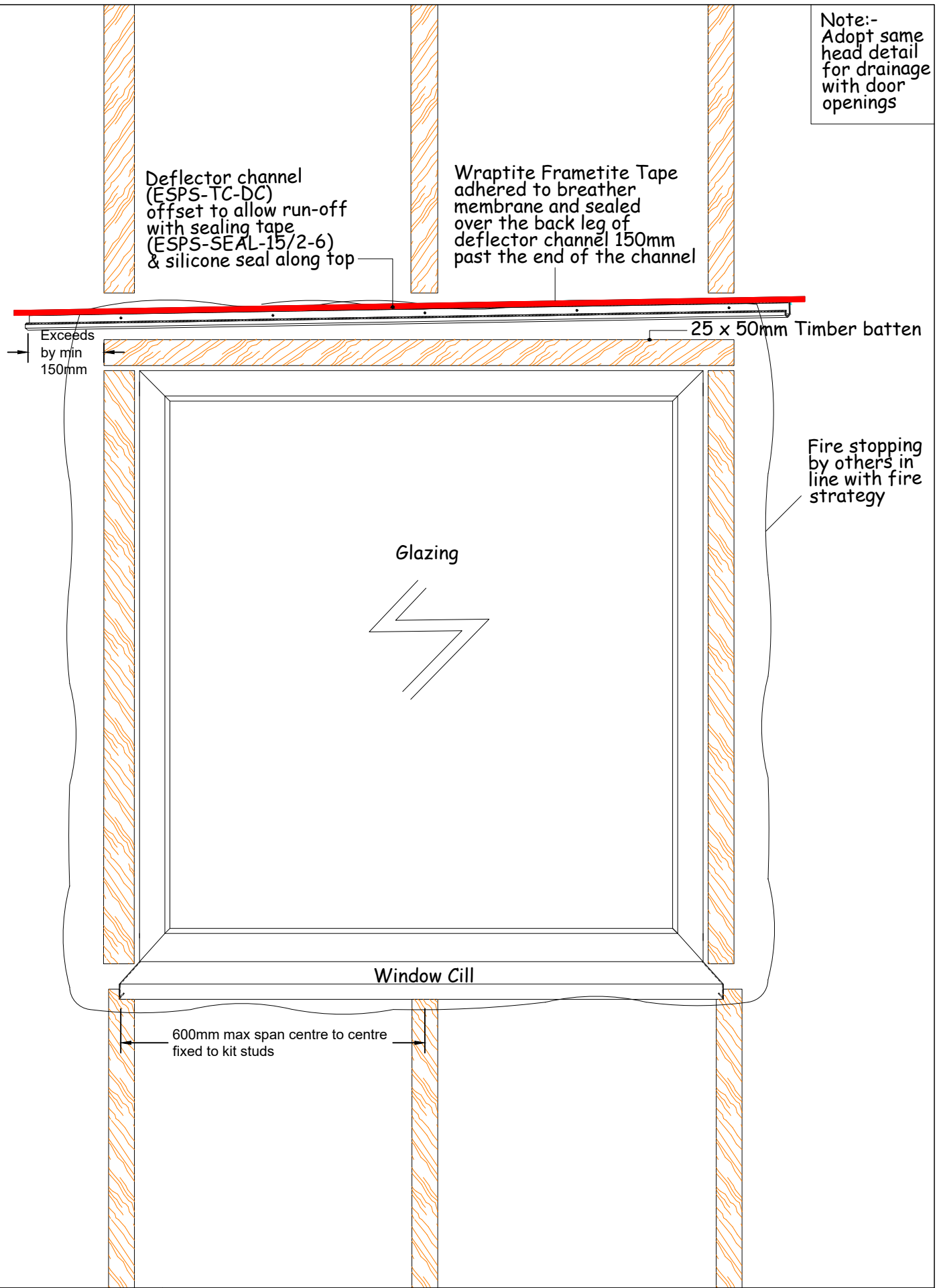

Deflector channel
(ESPS-TC-DC)
offset to allow run-off
with sealing tape
(ESPS-SEAL-15/2-6)
& silicone seal along top

Wraptite Frametite Tape
adhered to breather
membrane and sealed
over the back leg of
deflector channel 150mm
past the end of the channel

Exceeds
by min
150mm

25 x 50mm Timber batten

Fire stopping
by others in
line with fire
strategy

Glazing

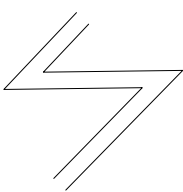

Window Cill

600mm max span centre to centre
fixed to kit studs

REV.	AMENDMENTS	DATE	PROJECT	DRAWING I.D.	<small>0:\Users\David\EnglishWork\Projects\Light\spenswall\top.dwg v16.pjs</small> SPSenvirowall Limited Orchard House Aire Valley Business Centre Keighley Yorkshire BD21 3DU Telephone: 01535 661 633 Fax: 01535 661 933
			SPSenvirowall Standard Details	PHASE ____ ISSUE ____	
			DESCRIPTION RendaClad onto Timber Battens	SYSTEM ID. No. SCALE DATE 1:10 @ A4 March 2017	
			DETAIL Window Elevation with Drainage Channel	DRAWN Auto CAD	