



About Benx

From masonry to framed construction, high to low rise, internal to external wall linings, Benx offers a solution.



As a leading UK facades supplier, Benx is continuously evolving its portfolio of products and systems in line with changing legislation, new material technologies and increasingly sophisticated building designs.

Furthermore, because we have developed a complete range of products and support services, we can offer you a comprehensive range from sheathing boards, through support structures to façade finishes. A single-source “Golden Thread” for the life of the building.

Our aim is to offer you more choice while reducing your risk in choosing and designing building façades. We believe our approach is the future of façades.



Our Portfolio

Benx are unique as a designer and supplier of façade systems with a comprehensive portfolio. We offer the complete through-wall solution:

- Façades
- Sheathing board
- Support Frame
- Rainscreen Insulation
- Cavity Barriers
- Airtight Solutions
- Market leader in the supply of external wall insulation

Rainscreen Insulation

Cavity Barriers

Airtight Solutions

Support Frame

Façade Range

Sheathing Boards

<p>Vwall</p> <p>Calcium Silicate/Fibre Cement A1 Non-Combustible BBA Approved</p>	<p>CEMBOARD</p> <p>Cement Bonded Particle Board Excellent Mechanical Strength Excellent Acoustic Properties</p>
<p>Multipurpose</p> <p>Cellulose Fibre Cement A Non-Combustible BBA Approved</p>	<p>DensGlass</p> <p>Fibreglass Mat with a Gypsum Core A1 Non-Combustible No.1 Specified Gypsum Sheathing Board in the US</p>

About SPS envirowall RendaClad System

RendaClad has primarily been developed to provide a seamless rendered rainscreen system to a timber frame structure. It replaces the need to build a blockwork façade, with low performance cementitious renders. RendaClad increases the speed of construction, reduces the building footprint, improves the logistics of supply and storage all at a lower cost than traditional construction methods.

RendaClad is a full façade system made up of carefully selected components which have been rigorously tested individually and as an entire system, making it one of a very few BBA approved systems of its type, assuring its longterm performance.

Render-to-board applications have previously been fraught with issues relating to cracking and de-lamination. RendaClad provides a low-cost solution guaranteed not to crack and is able to accommodate the expected settlement and differential movement within timber frame construction. In addition, silicone render finishes give long term durability and a high-resistance to dirt retention and algal spoiling, resulting in a highly durable render system with a minimum life expectancy of 30 years.





The Benefits

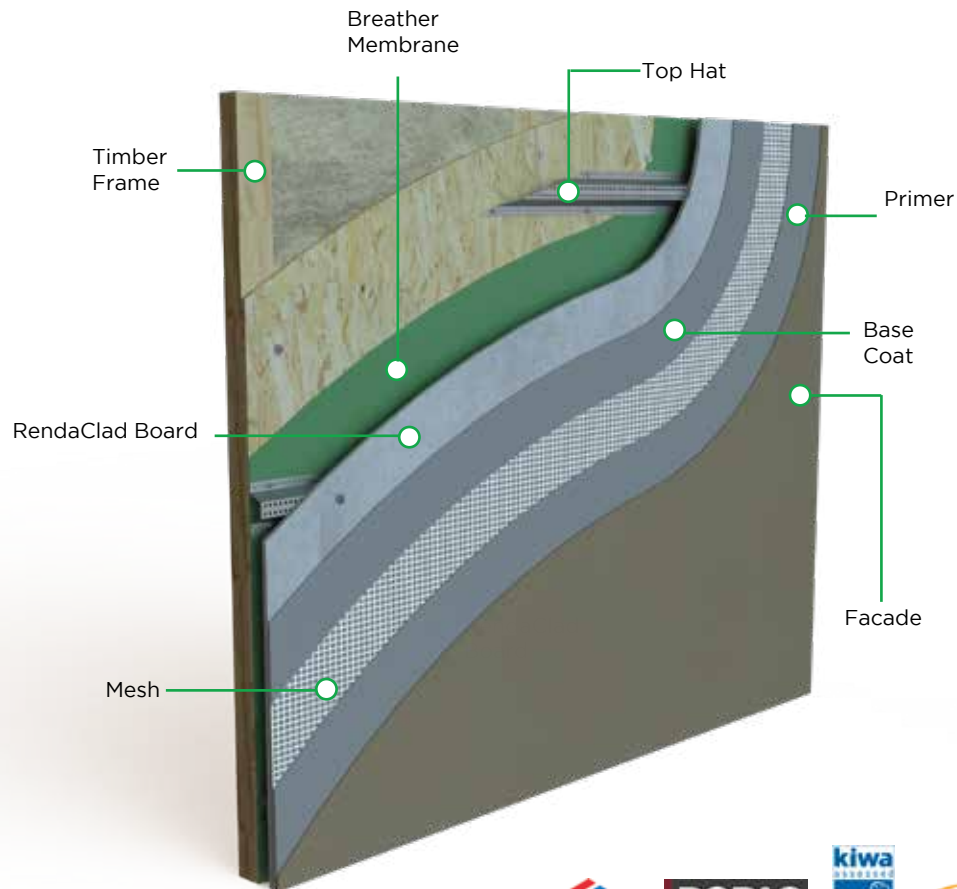

- Extensive accreditation including BBA and BOPAS
- Fast method of construction, reducing prelims per plot
- Significant size footprint savings per elevation
- A typical RendaClad system is 40-45mm from sheathing board, compared to approx. 170mm for masonry with render
- Crack resistant
- Choice of renders, brick & stone slips options on same carrier structure
- Lightweight
- Less storage required onsite
- 30 & 60 year minimum design life accreditations options available
- All key components A2-s1-d0 or better available



The Finishes



Enviromin

Enviromin is a high-performance cement based and polymer modified through coloured mineral thin coat render.

EnviroCryl

Acrylic polymer based top coat supplied in various grain sizes offering a highly water repellent finish in a wide range of colours.

FlexiSil

FlexiSil's acrylic base with silicone enhanced additives give it the flexibility and extensive colour choice of acrylic.

EnviroSil

Silicone based top coat supplied in various grain sizes in a range of colours offering greater water repellency, vapour permeability and lower dirt retention.

SpeedySlip & Flex-i-Slip

SpeedySlip & Flex-i-Slip provides the traditional appearance of a brick finished building but with the technology of a lightweight or mineral brick slip finish.

Supertech

Supertech Weatherboard is a fully ventilated rainscreen cladding system which has an appearance similar to that of traditional timber



Case Study

Skerries Road

Skerries Road Southway Campus in Plymouth comprises of 67 timber frame units

Originally to be built with traditional block work, the design was changed to accommodate the innovative RendaClad facade system. The programme was delivered 3 months ahead of schedule on the overall contract when utilising a form of modern methods of construction with the use of SPSEnvirowall's RendaClad.

By utilising RendaClad, what would have been a delivery of traditional blocks by 70 articulated vehicles for the external outer leaf was reduced to only 4 loads to deliver the proprietary rain screen solution carrier board. This saved significant embodied energy within the manufacturing process of blockwork and a reduction of CO2 emissions with the reduced transportation.

Adaptions to the substructure package resulted in financial savings and the reduction of removal of land waste due to the lightweight nature of the superstructure and façade finish.



Case Study

Langdon Hospital

Langdon Hospital is a new mental health facility in Dawlish, Devon, designed to ensure the safety of both patients and staff by providing a robust construction capable of withstanding any attempt to damage the external facades.

The substrate was created off-site using the Kingspan panel solution that was pre-boarded utilising the RCM Y Wall sheathing board.

This frame had to withstand the potential physical abuse of the occupiers in which a double boarding method with a layer of aluminium sheeting in between was used.

The SPSenvirowall 9mm RendaClad board, adhesively and mechanically fixed onto 200mm EPS and sheathing board was used in areas up to 2.4 meters and incorporates a high impact mesh there on after. This proposal had to pass a series of stringent impact resistance tests before the NHS could be satisfied that it met with their requirements.

A nano equalising paint was applied as a special finish, providing self-cleaning properties to the white facade and emphasising the eye-catching colour variations of the feature panels.



Case Study

Junction 3

The Junction 3 development comprises of 59 affordable homes incorporating sustainable, energy-saving materials, also generating a Creative Learning Zone, library, crèche, community meeting rooms, and seven retail units. The homes were built to the Code for Sustainable Homes Level 3, while the other elements of the project all achieved a BREEAM 'Very Good' rating.

With such a variance of substrate changes this utilised a variety of SPSEnirowall BBA approved render solutions and finishes and required the technical abilities of the design team from all companies to interface these abutment details amongst others accordingly.

With feature curve walls, waving bulkheads and interchanging colours between the renders, the SPSEnirowall RendaClad system was the perfect choice for installation onto the varying substrates which consisted of timber frame, shear concrete walls, blockwork and a secondary steel frame and guaranteed delivery of a high quality finish.



Case Study

Granton Harbour

Located in the north of Edinburgh with convenient transport links and within easy reach of the city centre, the new 132-home development in Granton Harbour by Link Housing provides 1, 2 and 3-bed flats with waterfront living and coastline views.

SPSenvirowall supplied its RendaClad system comprising of 12mm RendaClad Lite fire-rated boards and utilising a high-performing white silicone primer and render topcoat (WH77) to the SFS construction.

The £400,000+ façade package benefits from a seamless rendered rain screen system and ensures that the wall structure has a fully ventilated and drained cavity.

The high-performance and BOPAS accredited system was an ideal solution for this construction due to its reduced construction time and cost of application.



Thank you for taking the time to review our RendaClad brochure.
If you require any further information on our products or services, please contact us.

Sales  0800 612 4662  sales@benx.co.uk

Technical  0800 488 0531  technicalservices@benx.co.uk  www.benx.co.uk



Disclaimer

By using or accessing the brochure, you agree with the following Disclaimer. Benx Limited ('the Company') reserves the right to terminate, revoke, modify, alter, add and delete any of the information in the brochure. The Company shall be under no obligation to notify the user of the amendment to the contents of the brochure. Computer generated images, walkthroughs and render images used on this brochure are the artist's impression and are an indicative of the actual designs

The information in this brochure is presented as general information and no representation or warranty is expressly or impliedly given as to its accuracy, completeness or correctness. It does not constitute part of a legal offer or contract. While every effort has been made to ensure its accuracy, this brochure may unintentionally include inaccuracies or errors. The user must verify all the details and specifications independently with the Company prior to concluding any decision to purchase or use the Company's products.

In no event shall the Company be liable to the user or any third party for damages, losses and causes of action (including but not limited to negligence), errors, injury, whether direct, indirect, consequential or incidental, suffered or incurred by any person/s or due to any use and/or inability to use this brochure or information, action taken or abstained through this brochure. While every effort has been made by the Company to ensure that information in the brochure is up to date, accurate and correct, the users are requested to make their independent enquiry before relying upon the same.